



MASTER MHN-LA

MASTER MHN-LA 1000W/842 230V XWH

Compact quartz metal halide lamps with double-pin

Product data

• General Information

Cap base	X528 [X528]
Burning Position	P5 [Parallel +/-5D or Horizontal(HOR)]
Life to 5% failures (nom.)	6000 h
Life to 10% failures (nom.)	8000 h
Life to 20% failures (nom.)	10000 h
Life to 50% failures (nom.)	15000 h

• Light Technical

Lamp Luminous Flux (Min)	85800 lm
Lamp Luminous Flux (Nom)	95800 lm
Colour Designation	Cool White (CW)
Lumen maintenance 1,000 hours (nom.)	90 %
Lumen maintenance 2,000 hours (nom.)	80 %
Chromaticity coordinate X (nom.)	366
Chromaticity coordinate Y (nom.)	370
Colour Temperature, horizontal (Nom)	4200 K
Lamp Luminous Efficacy EM (Nom)	92.00 lm/W
Colour Rendering Index,horiz (Nom)	70

• Operating and Electrical

Lamp supply voltage	230 V [230]
Power (Rated) (Nom)	1000 W
Lamp current run-up (max.)	15 A
Lamp current (EM) (nom.)	9.3 A
Ignition supply voltage (min.)	198 V
Voltage (Max)	140 V
Voltage (Min)	110 V
Voltage (Nom)	230 V

• Controls and Dimming

Dimmable	no
----------	----

• Mechanical and Housing

Bulb finish	Clear (CL)
Cap base information	Cable (C)

• Approval and Application

Energy efficiency label (EEL)	A+
Mercury (Hg) content (nom.)	112 mg
Energy Consumption kWh/1000 h	1144 kWh

• UV

Specific eff. radiant power	265 mW/klm
-----------------------------	------------

PHILIPS

MASTER MHN-LA

• Luminaire Design Requirements

Bulb temperature (max.) 920 °C
Pinch temperature (max.) 350 °C

• Product Data

Full product code 871150020078500
Order product name MASTER MHN-LA 1000W/842 230V XWH
XWH

EAN/UPC – product 8718291548232
Order code 20078500
Local Code 9280-730-05130
Numerator – quantity per pack 1
Numerator – packs per outer box 1
Material no. (12NC) 928073005130
Net weight (piece) 141.000 g
ILCOS Code MN-1000-E-K-/H

Warnings and Safety

- Use only in totally enclosed luminaire, even during testing (IEC61167, IEC 62035, IEC60598)
- The luminaire must be able to contain hot lamp parts if the lamp ruptures

- A lamp breaking is extremely unlikely to have any impact on your health. If a lamp breaks, ventilate the room for 30 minutes and remove the parts, preferably with gloves. Put them in a sealed plastic bag and take it to your local waste facilities for recycling. Do not use a vacuum cleaner.

Dimensional drawing

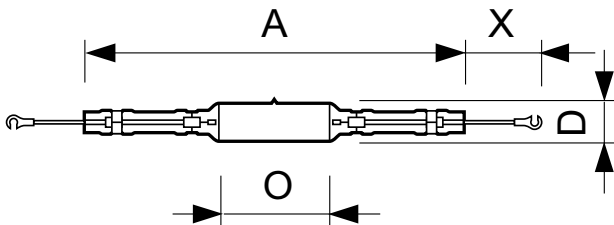

MHN-LA, 1000W/2000W

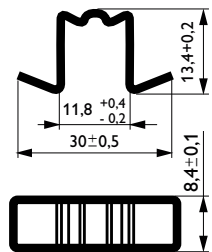

MHN-LA 1000W/842 230V XWH

Product	D	O	X	A
MASTER MHN-LA 1000W/842 230V XWH	40 mm	40.5 mm	35 mm	286 mm

Photometric data

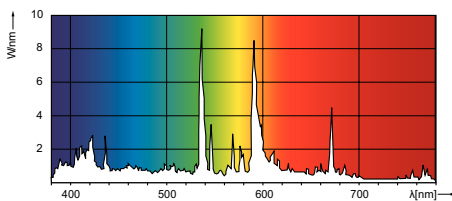



© 2016 Philips Lighting Holding B.V.
All rights reserved.

Specifications are subject to change without notice. Trademarks are the property of Koninklijke Philips N.V. (Royal Philips) or their respective owners.

www.philips.com/lighting

2016, March 7
data subject to change